

AutoCAD 2010: One Step at a Time
Lesson 18: Leaders

10R18	Exercises
--------------	------------------

1. Create the drawing shown.

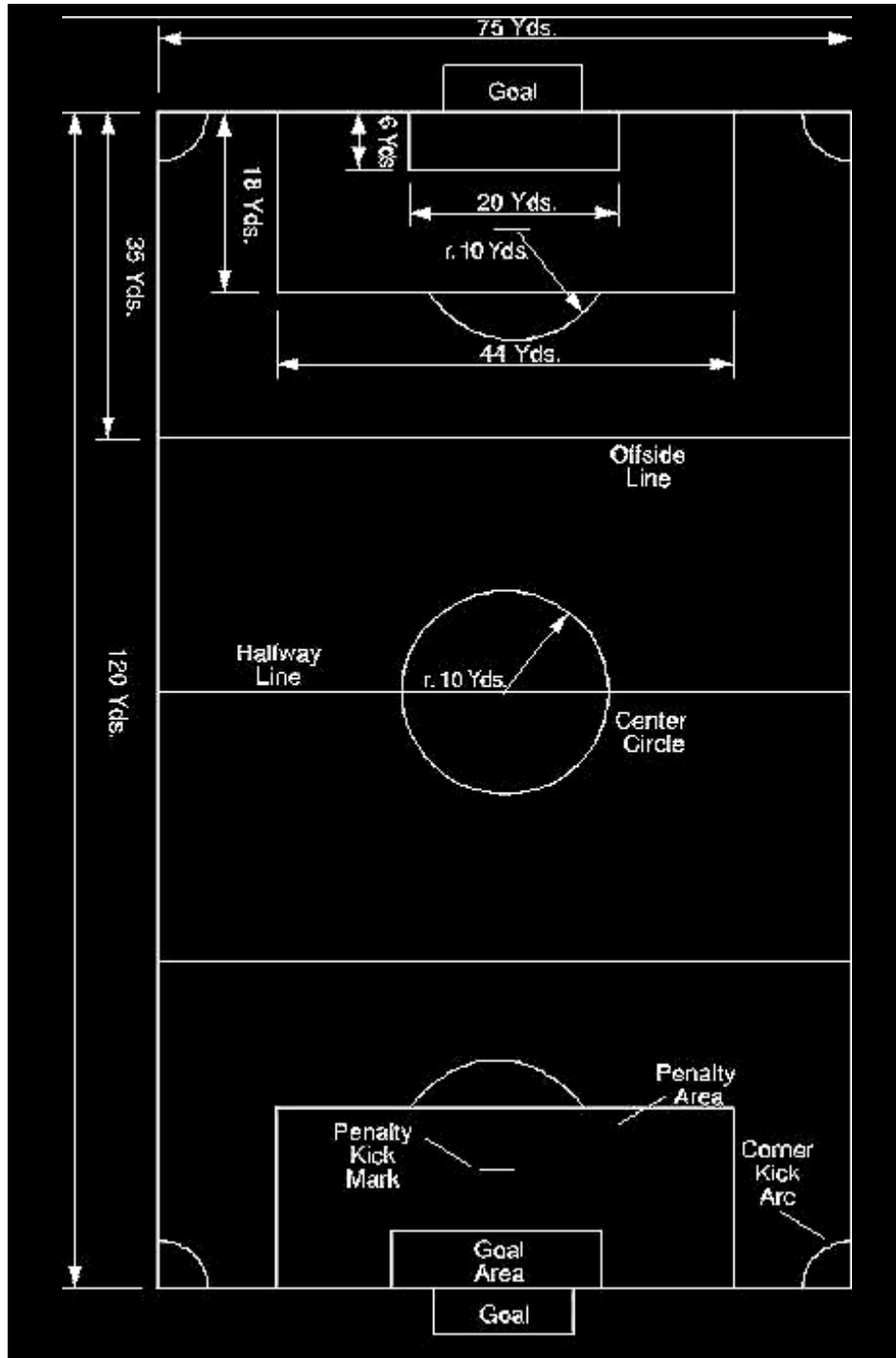

2. Add the callouts to the brake you dimensioned in Lesson 16.

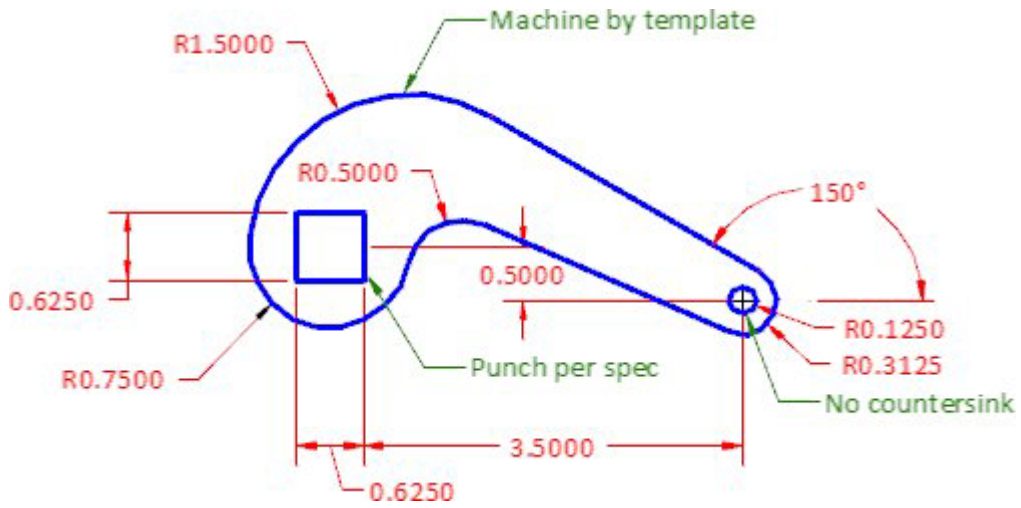

3. Add the callouts to the pulley-slider you dimensioned in Lesson 16.

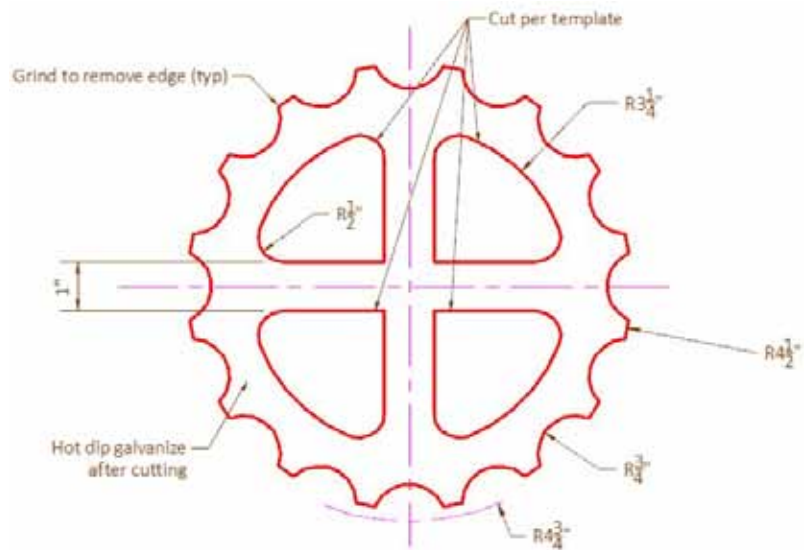

Write your answers on a separate sheet of paper.

1. Use the _____ command to place simple call outs that require an arrow or line to reference an object.

Identify these buttons.



2. 3. 4. 5. 6.

7. (T or F) The MLeader command can place bubbled callouts.
8. To align leaders, use the _____ command.
9. To gather bubbled leaders into a single leader, use the _____ command.

Customize leaders with the (10) manager accessed with the (11) command.

10.

11.

12. Select to create a splined leader on the _____ tab of the Multileader Style dialog box.

Select to create bubbled leaders from the (73) control box on the (74) tab of the Multileader Style dialog box.

13.

14.

Answers

- | | | |
|------------------------|-----------------------|----------------------|
| 1. MLeader | 6. Multileader Style | 11. MLeaderStyle |
| 2. Add Leader | 7. T | 12. Leader Format |
| 3. Multileader Align | 8. MLeaderAlign | 13. Multileader type |
| 4. Multileader | 9. MLeaderCollect | 14. Content |
| 5. Multileader Collect | 10. Multileader Style | |